

**POT BEARING HOUSING ASSEMBLIES
FOR VOLKMANN MANUAL & AIR THREADED POTS
06 BA4
REBUILD SERVICE**

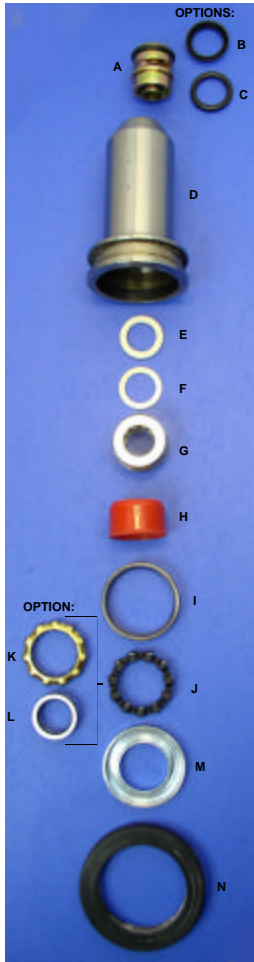

REBUILDING POT BEARING HOUSINGS: The used assembly is disassembled, cleaned and inspected. Epic **always** replaces the felt sealing washer (E), upper needle bearing (G), nylon spacer bushing (H), lower outer race (I), and bearing cage (customer to specify polyamide (J) or brass (K)). Any static parts that show wear or faults are also replaced. The rebuilt assembly is lubricated with Kluber synthetic grease.

The rebuilt pot bearing housings function “like new”, at a significant savings to the customer.

Because it is good practice to replace the inner race (L) on the upper spindle blade when replacing the bearing cage, polyamide (J) or brass (K), a new inner race (L) is also supplied with the exchange or rebuilt assembly when the brass bearing cage is used.

- (A) EE481246: Injector Complete
- (B) EE481206: Seal Ring for Injector & Plunger
- (C) EE435058: O-Ring, 15x3
- (D) EE481355: Steel Shell
- (E) EE480740: Top Felt Washer
- (F) EE481249: Top Metal Washer
- (G) EE401994-2: Top Needle Bearing with Washers
- (H) EE401914: Nylon Spacer Bushing
- (I) EE401909: Outer Race, E-15
- (J) EE401910-1: Bearing Cage, Polyamide, E-15
- (K) EE401910: Bearing Cage, Brass, E-15
- (L) EE401911: Inner Race, E-15
- (M) EE481247: Labyrinth Ring, E-15
- (N) EE481248: Rubber Damping Protection Ring

OEM #	Epic #	Description
(170555) (236992) (244038) (270181)	EE402168	REBUILD Customer's Complete Pot Bearing Housing
170555 236992 244038 270181	EE402023	NEW Pot Bearing Housing Complete, 06, BA4

